

## CART IS NOT CHARGING AND/OR PC TURNS OFF WHEN UNPLUGGED

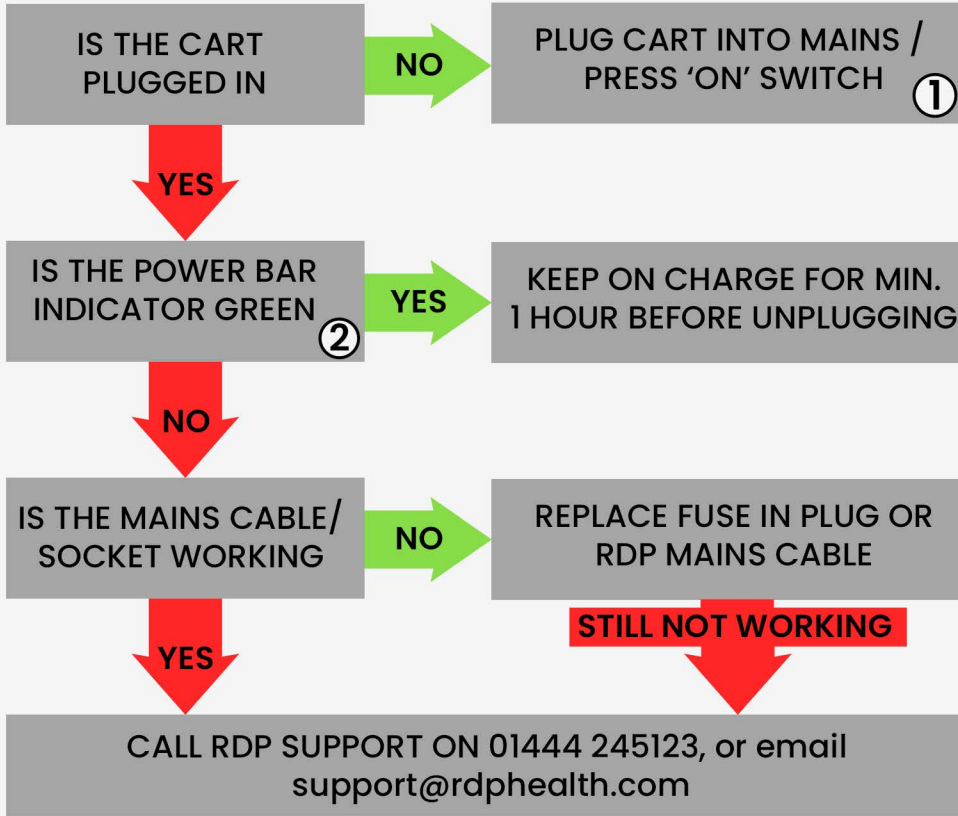

## IMPORTANT.

KEEP RDP COILED CABLE CONNECTED TO CART AT ALL TIMES.

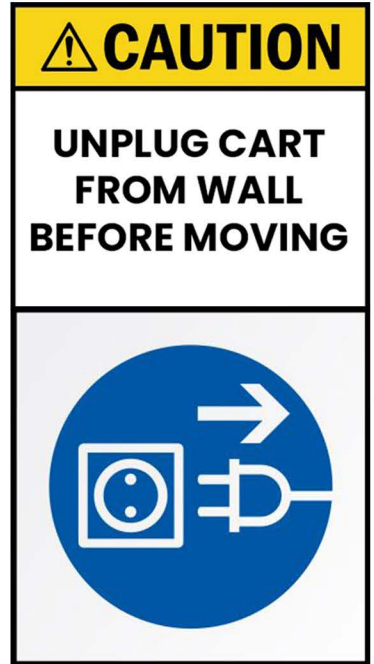

## ELECTRIC HEIGHT ADJUSTMENT NOT WORKING

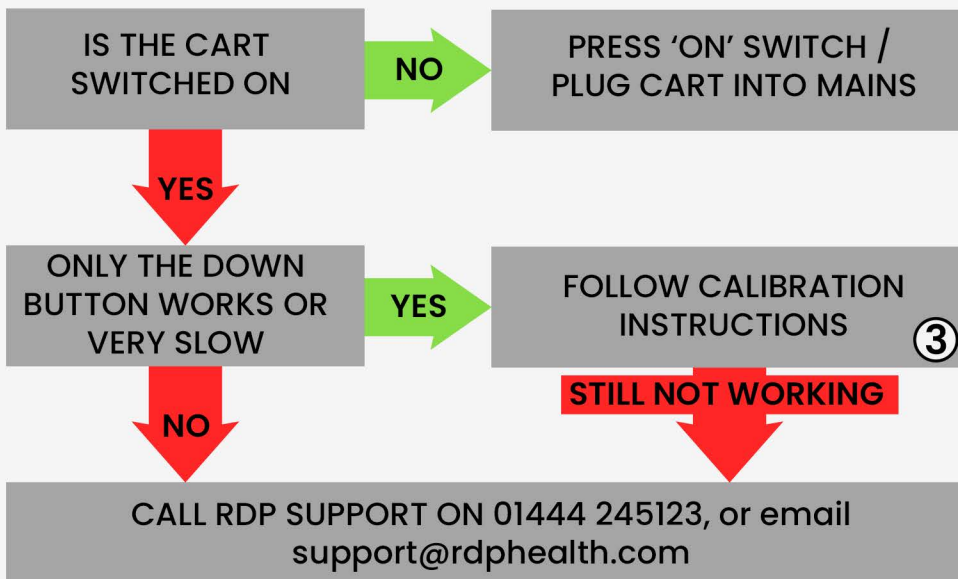

### Strut Controller

Press and hold the corresponding height adjustment button in order to raise or lower the work surface.

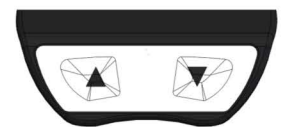

### ③ Strut Calibration

Lower the cart to its lowest position, then press and hold the 'down' button for approximately 5 seconds until you hear a distinct clicking sound. The strut should then operate at an increased speed.



## 1 On/Off Switch Location

Press to turn on / Hold down for 5 seconds to turn off.

Please Note, All carts will power on automatically when plugged in to mains.

**nano** Located - Base of Power-slice

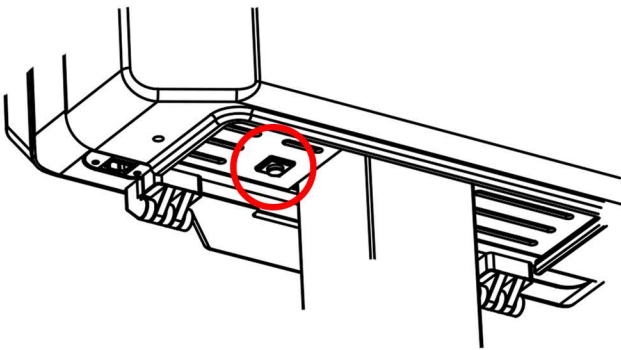

**nova** Located - Base of Power-slice

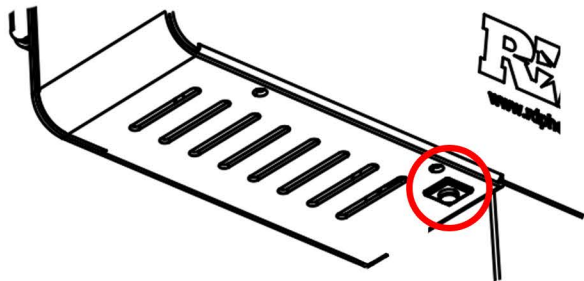

**cube** Located - Front Of Cart

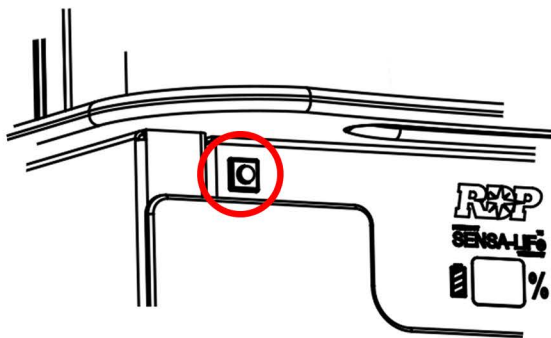

## 2 Battery Display Info. NANO & NOVA

When the cart's power level is low, the LED bar will flash red, and the cart will emit a beeping sound to indicate that it requires charging.

While the cart is charging, the 'power bar' will gradually fill up with a green indicator.

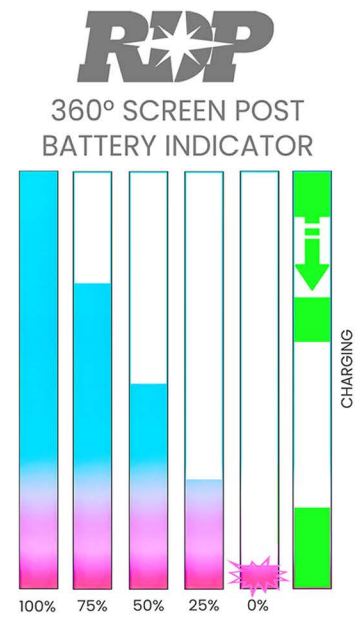

## Battery Display Info. CUBE

When the cart's power is running low, an alarm will sound, and the indicator will flash red, indicating the cart needs charging.

