

HUBB Wall Mount Solution - Assembly Instructions

FIXING PACK CONTENTS

2x M6 Nut

2x M6 washer

2x M6 nut cap

1x M8—30mm Flanged Screw

2x M5 - 8mm CSK Screw

1x 20mm Nylon Spacer

TOOLS REQUIRED (INCLUDED IN FIXING PACK)

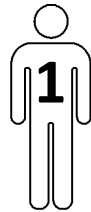
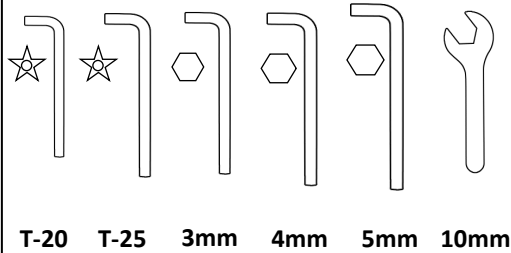

20 MINUTES

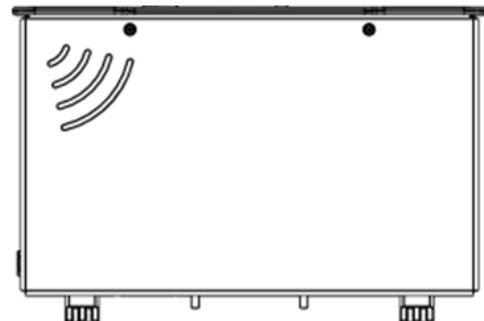
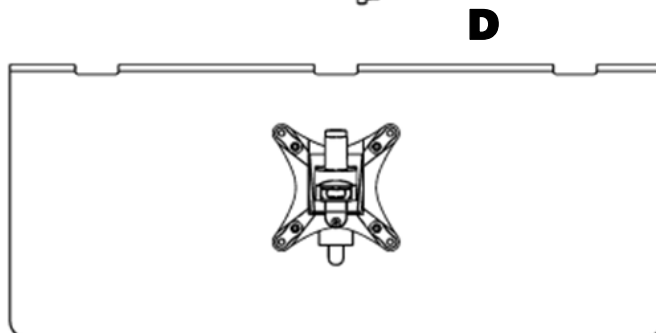
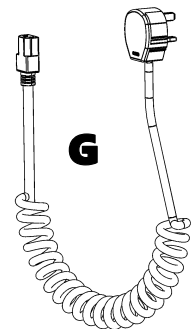
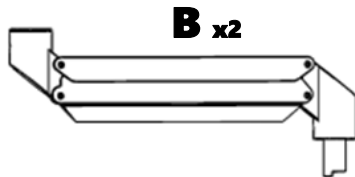
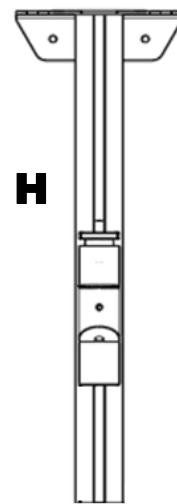
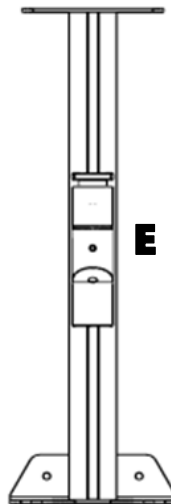
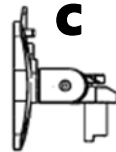
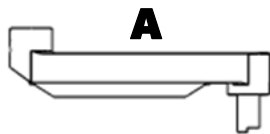
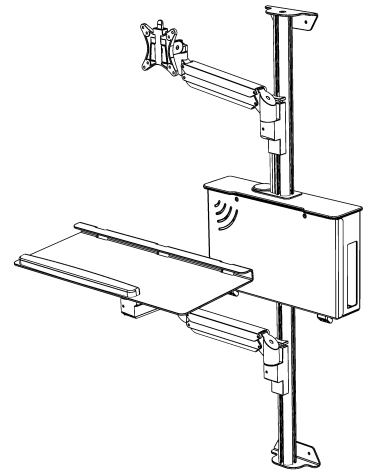

NEED HELP OR ADVICE?

Call our Support Team on 01444 245123 or email support@rdphealth.com

IMPORTANT: Failure to use the correct fixings in the correct place may result in product damage.

CONNECTING TOP POST TO PC CASE



Position 20mm nylon spacer & fit top post (H) to PC case (F). Secure with 1x M8 - 30mm screw.

1 X 20mm Nylon Spacer
IMPORTANT: Insert nylon spacer into front channel on post before securing to PC case.

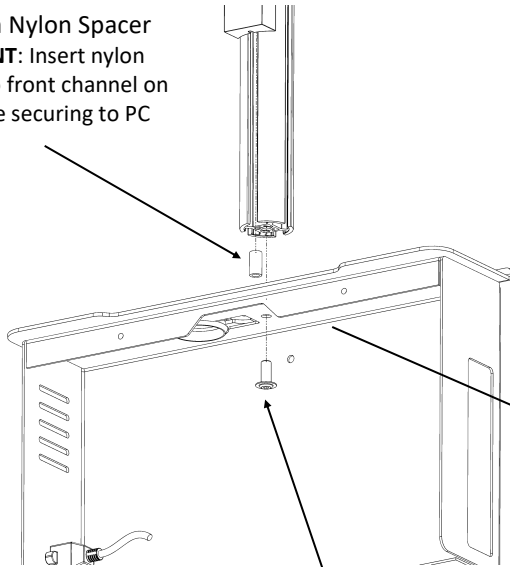

1 X M8 - 30mm
Flanged Screw

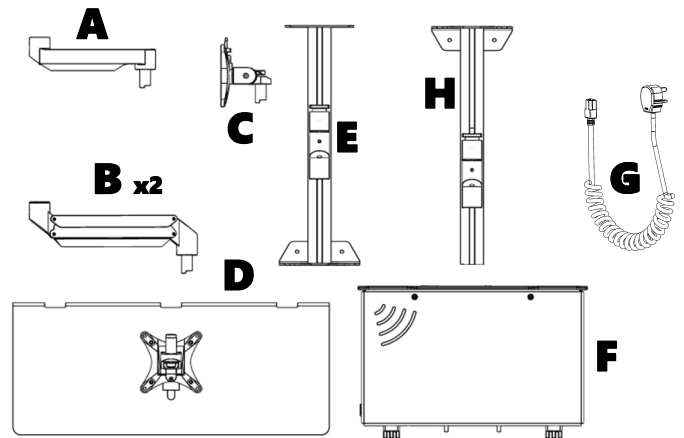

CONNECTING BASE POST TO PC CASE



Fit bottom post (E) to PC case (F) & secure with 2x M6 washers, nuts & nut caps provided.

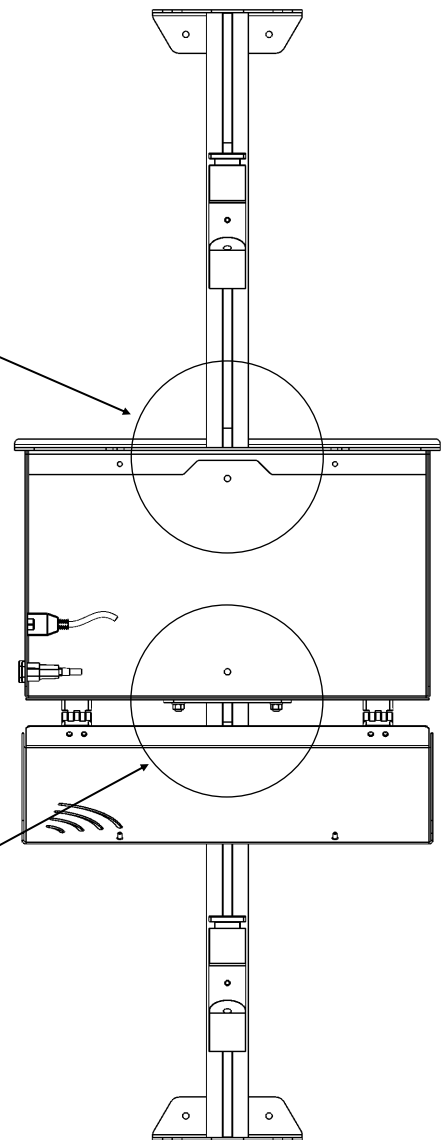
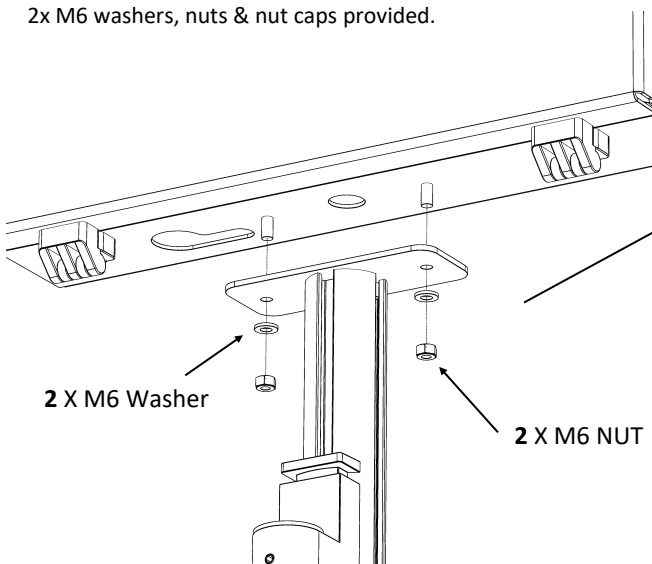



MARKING FIXING HOLES

MARKING UP: Mark position for top & bottom bracket - 4x Positions

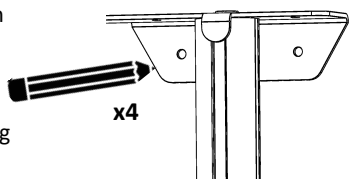

Mark position for PC Case fixing - 2x Position

Use a level to ensure unit is straight when fitting

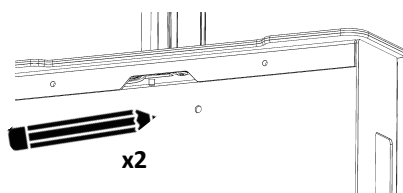

ATTACHING HUBB

Once wall plugs are inserted into all 6 holes, screw in unit.

IMPORTANT - ENSURE SUITABLE FIXINGS ARE USED FOR WALL TYPE

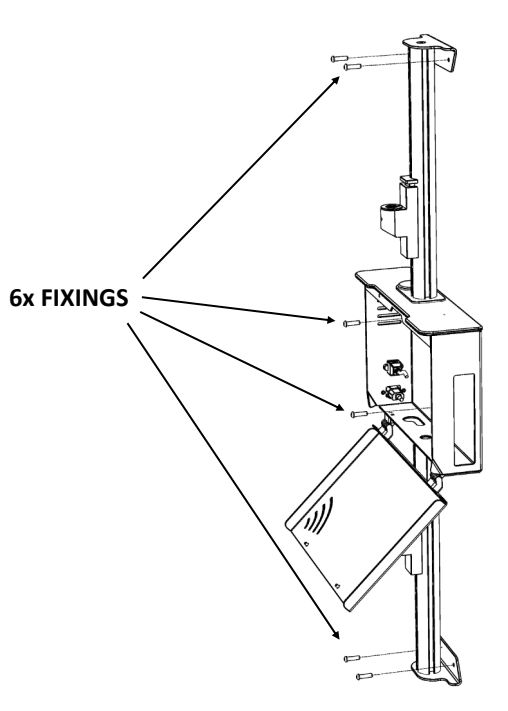

IMPORTANT - Choosing the correct position

The measurements given here are only a guide and it is the installer/end users responsibility to position the unit correctly.

FIXING POSITION

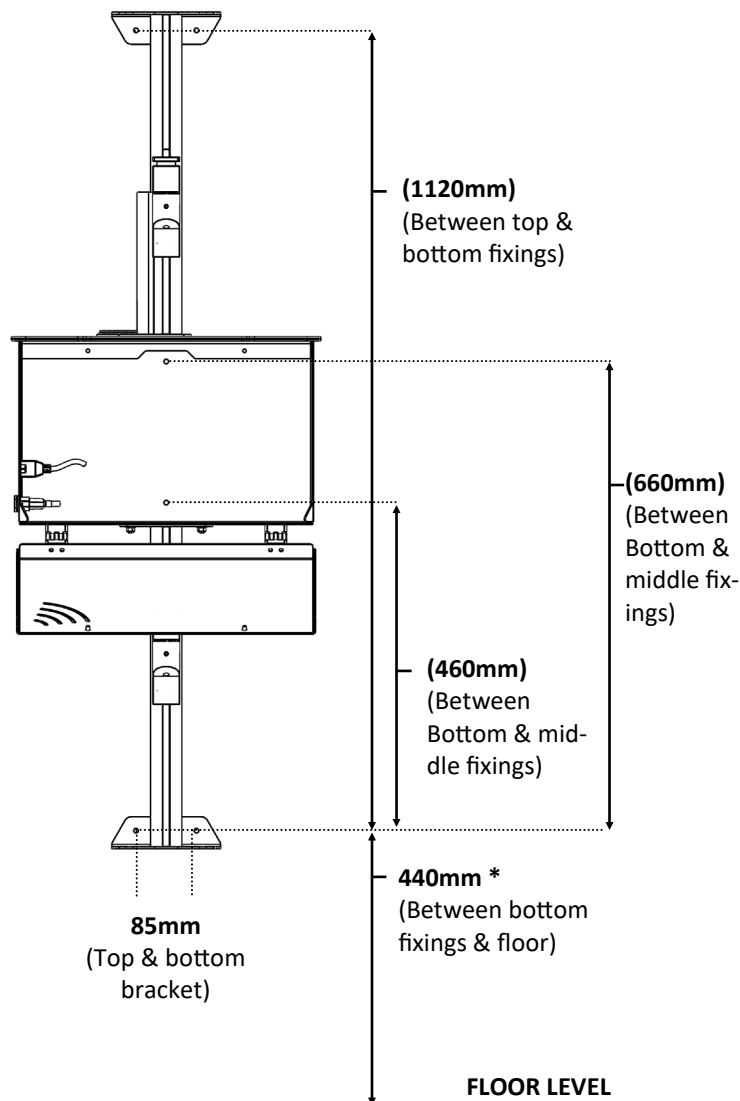

* See 'Features & Dimensions' document for range of movement



CABLE CHASE / GROMMET

Ensure both cable chase & grommet are in position for PC Fit.

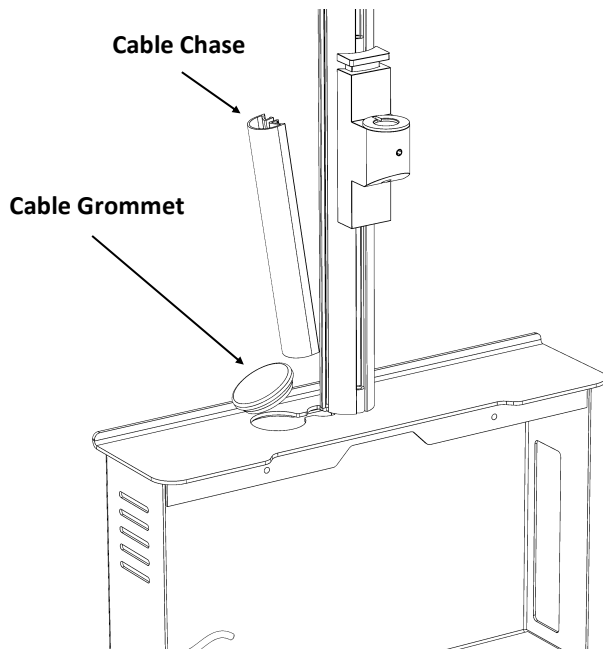

CLOSING PC CASE

Use 2x M5 CSK security screws provided to close PC Case (F).

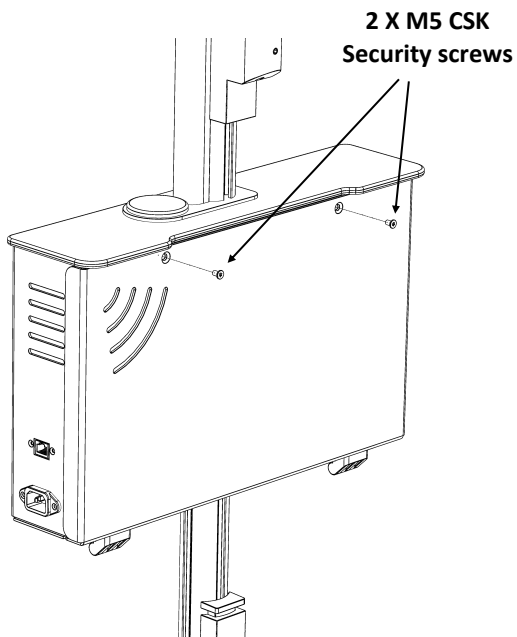

CONNECTING VESA HEAD & ARM

Push vesa head (C) into Dynamic Arm (B) then arm into top connector

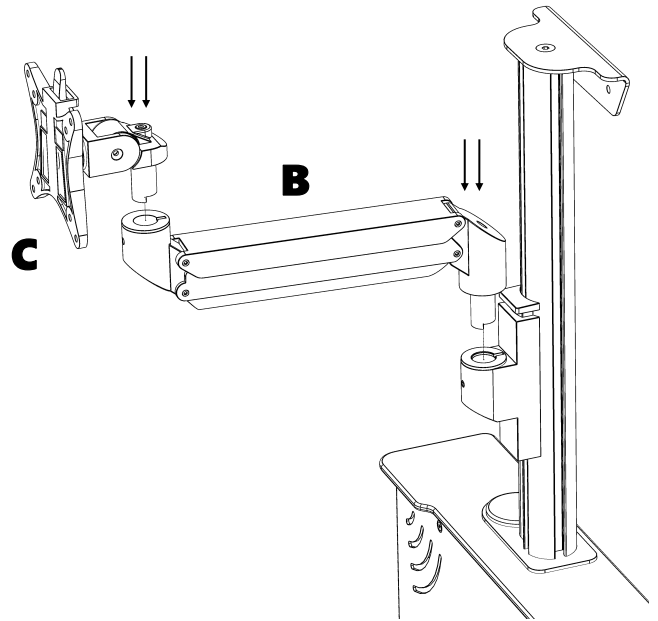

Secure connectors by tightening M4 screws with 3mm hex key provided - DO NOT OVERTIGHTEN

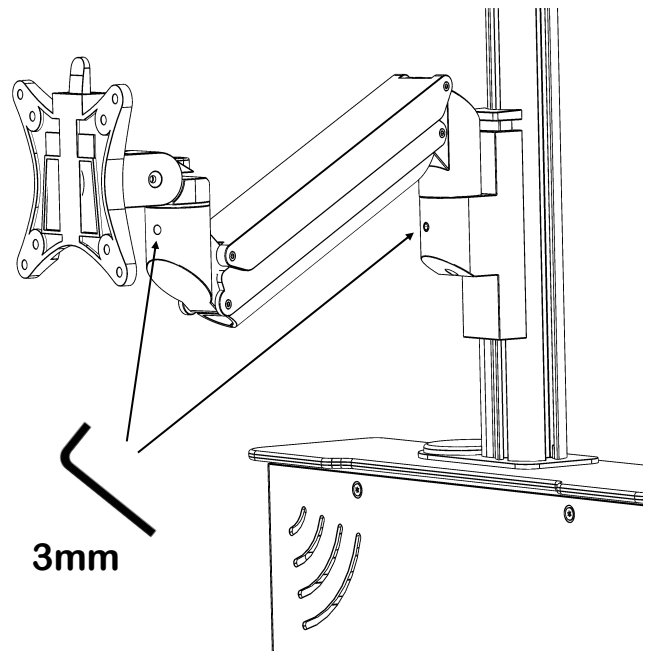



CONNECTING KEYBOARD TRAY & ARMS

Push keyboard tray (D), into arm (A) then into dynamic arm (B) then into bottom connector

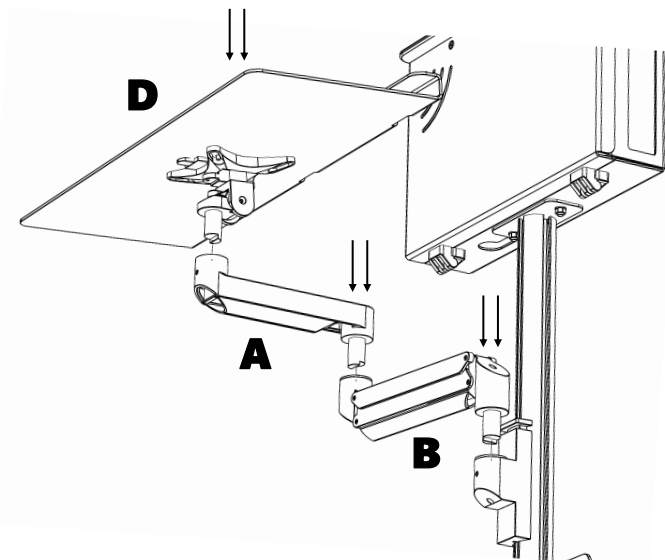

Secure connectors by tightening M4 screws with 3mm hex key provided - DO NOT OVERTIGHTEN

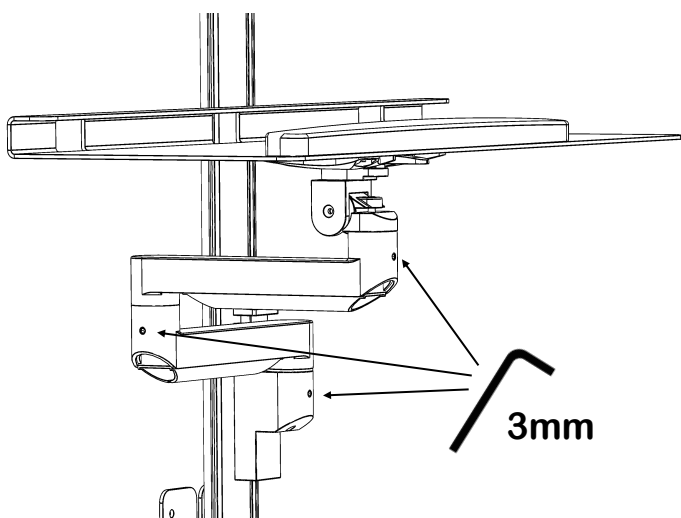

POWER LEAD

Connect power lead into IEC connector at the side of the PC case & plug into wall socket when unit is ready for power

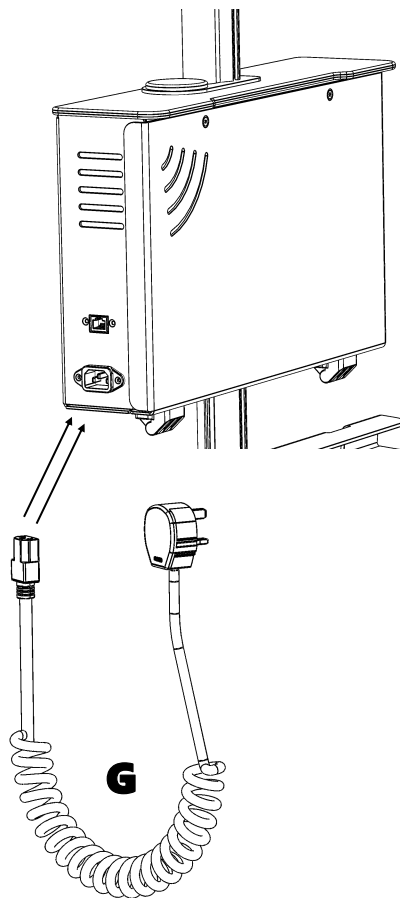

COMPLETE PC FIT

Once HUBB assembly is complete, see O&M Manual for 'PC FIT OPERATIONS'

